

2 DEMOLITION REFLECTED CEILING PLAN
1/4" = 1'-0"

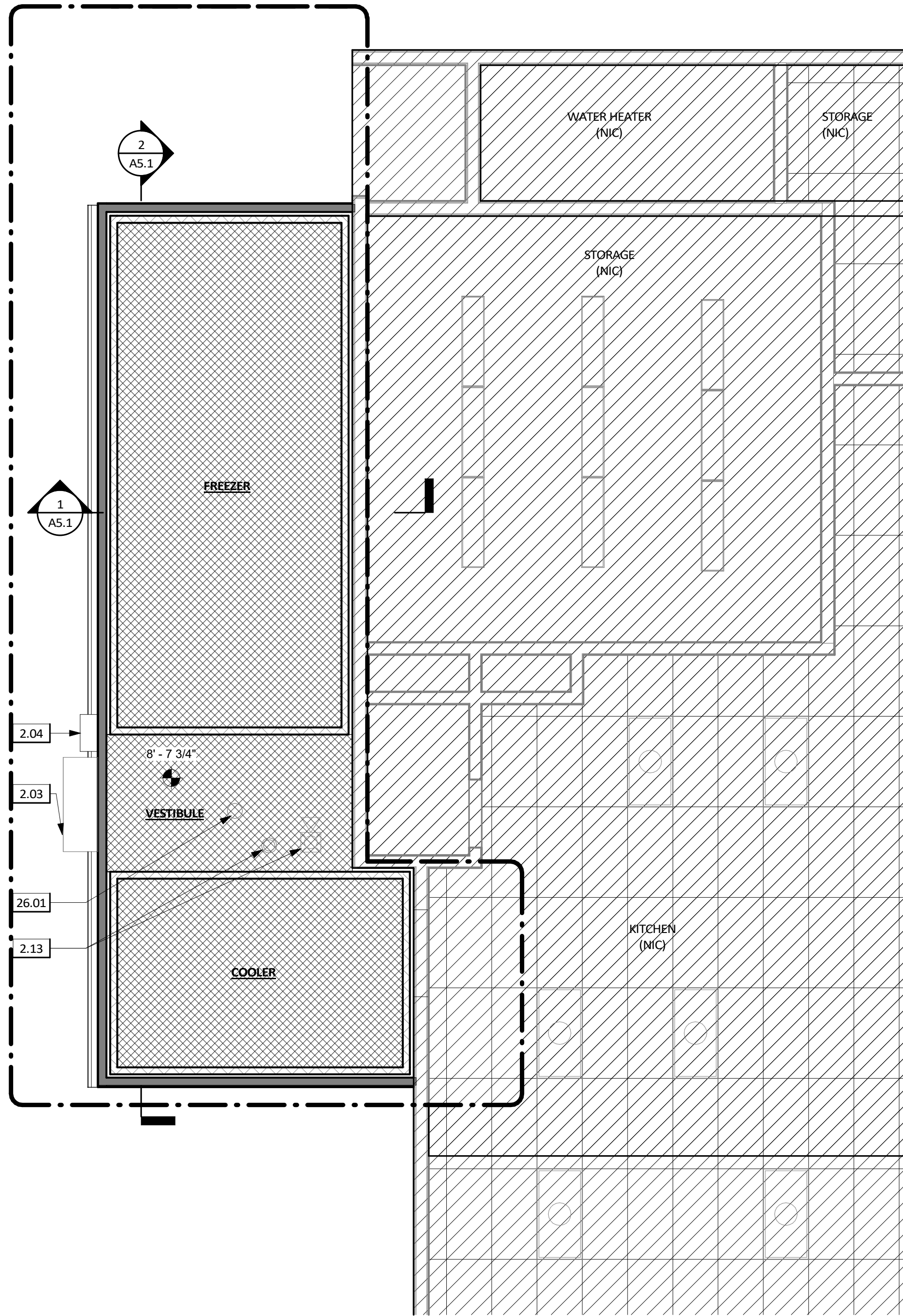

1 PROPOSED REFLECTED CEILING PLAN
1/4" = 1'-0"

REFLECTED CEILING PLAN NOTES

1. CONTRACTOR TO FIELD VERIFY ALL DIMENSIONS.
2. ALL ITEMS REFERENCED ARE EXISTING UNO.
3. REFER TO GENERAL NOTES ON G1.0 - G1.3 FOR FURTHER INFORMATION & REQUIREMENTS.

REFLECTED CEILING PLAN LEGEND

- AREA OF WORK
- (E) TO REMAIN
- (E) TO BE REMOVED
- (E) WALL TO REMAIN
- WALL - SEE WALL SCHEDULE ON A8.1
- INSULATED WALL PANELS PER MFG - SEE WALL SCHEDULE ON A8.1
- CEILING PER MFG
- NOT IN SCOPE

KEYNOTES

- 2.03 (E) AIR CURTAIN TO BE SALVAGED AND REINSTALLED - PER MECHANICAL
- 2.04 (D) SURFACE MOUNTED EXTERIOR LIGHT FIXTURE TO BE SALVAGED AND REINSTALLED PER ELECTRICAL
- 2.13 (E) FIRE ALARM WITH RELATED CONDUIT TO BE REMOVED, SALVAGED AND REINSTALLED - PER ELECTRICAL
- 2.14 (E) CEILING MOUNT LIGHT FIXTURE WITH RELATED CONDUIT TO BE REMOVED - PER ELECTRICAL
- 2.58 (D) WALL MOUNTED LIGHT FIXTURE TO BE REMOVED PER ELECTRICAL
- 26.01 CEILING MOUNT LIGHT FIXTURE - PER MFG.

BOARD OF EDUCATION

ob/ARCHITECTURE

2419 EL CAJON BLVD, SAN DIEGO, CA 92104



FOR DSA REVIEW ONLY - NOT FOR CONSTRUCTION

REFLECTED CEILING PLAN NOTES

DEMOLITION AND PROPOSED REFLECTED CEILING PLAN

SAN DIEGO UNIFIED SCHOOL DISTRICT

KITCHEN MODIFICATIONS GROUP 6

BELL MIDDLE SCHOOL

620 BRIARWOOD RD,
SAN DIEGO, CA 92139

DSA SUBMITTAL SET

PROJECT NO. SDUF-006A

R.S. A.P.

FILE NAME

DATE 03/21/2025

REVISIONS

SHEET NO.

A2.1